

SINGLE GUIDE. INTEGRAL JAWS, CONCENTRIC CLAMPING, EQUIPPED WITH 1 SERIES CONSISTING OF 3 INTERNAL JAWS, 1 SERIES CONSISTING OF 3..

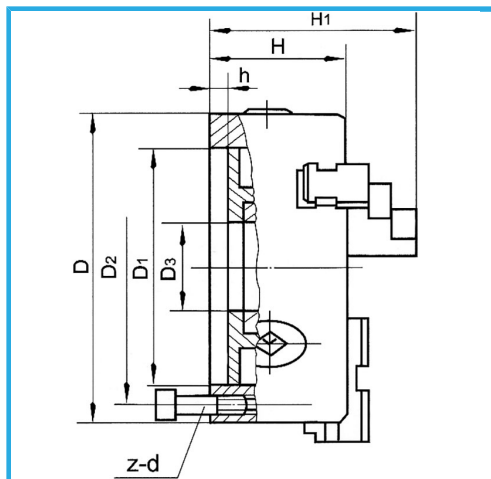

D	250 mm
D1	106,375 mm
D2	133,4 mm
D3	80 mm
H1	142 mm
H	98 mm
h	16 mm
z-d	6-M16 mm
Spanner square	12 mm
A - A1	6 - 110 mm
B - B1	80 - 250 mm
C - C1	90 - 250 mm
Pins	Ø 22 mm
Net weight	32,0 kg
Gross weight	34,00 kg
Packaging dimensions	-
EAN Code	8012667397890



Box



Wooden Box



Cast Iron